



WEST CREEK HOMES



*Rendering is an artists illustration only, actual home changes slightly

2326 SQ.FT

STONEFIELD

160 Legacy Reach Park

Features:

- o Enhanced Specification
- o Full Hardie Board siding
- o Railing (no stub walls)
- o Electric Fireplace
- o Oversized pantry
- o Walk-in closets in all upper floor bedrooms

Upgrades

- o Chef's Kitchen
- o 8ft Main Floor Doors



3 Bedroom



2.5 Bath

Clarity and Quality all the way home.



WESTCREEK HOMES

Contact Us | legacy@westcreekhomes.ca | westcreekhomes.ca

MAIN FLOOR 1006 SQ.FT

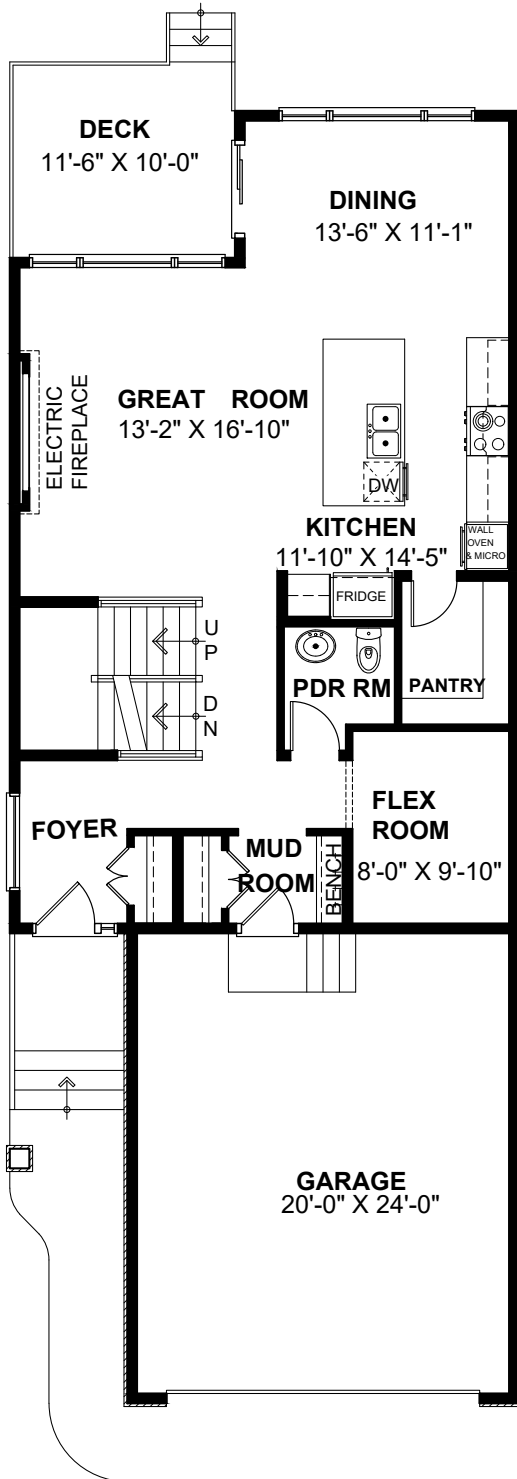

UPPER FLOOR 1320 SQ.FT

