

Aurora

9 - 198 WOLF HOLLOW RD

1224 sq.ft



*Rendering is an illustration only. The actual home will slightly differ.



WESTCREEK

HOMES

Contact Us
wolfwillow@westcreekhomes.ca
403.452.8496
westcreekhomes.ca



3 Bedroom



2.5 Baths

Main Level

586 sq.ft

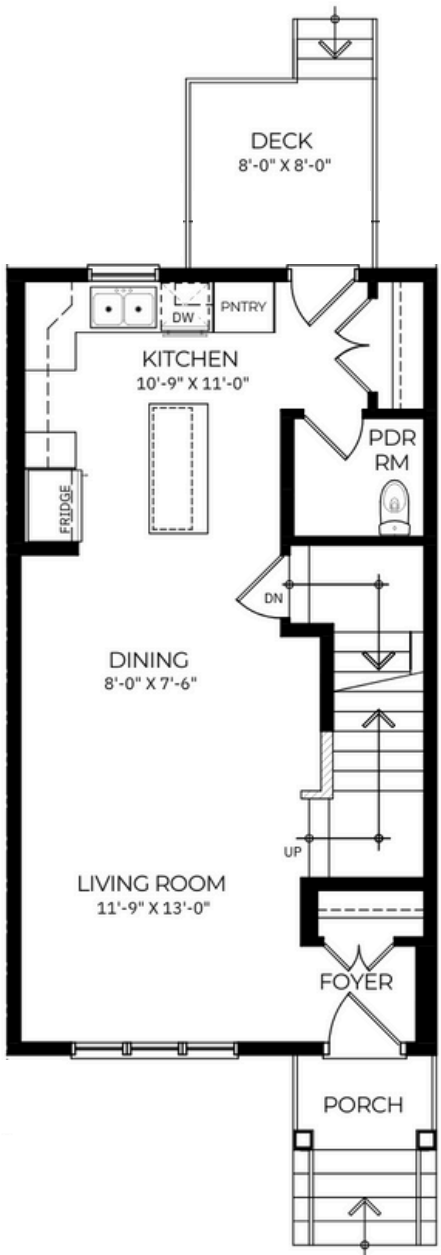

Upper Level

622 sq.ft

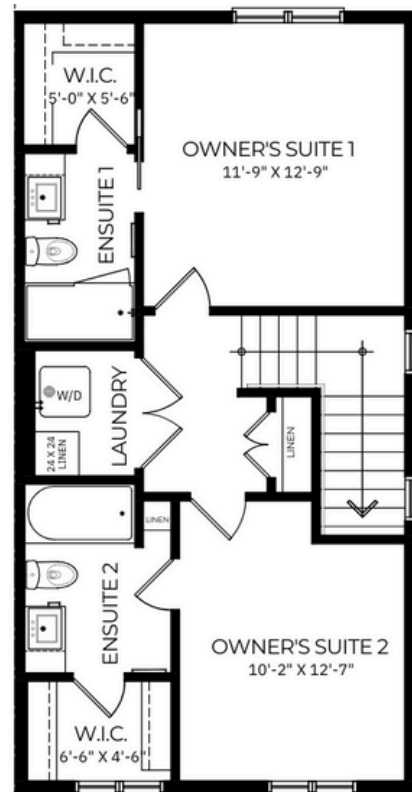

*Gold line indicates shared wall

Features:

- Finished basement
- Double detached garage
- Rear deck
- Open concept
- Owner's suite with walk-in closet

AURORA

Keep up to date with us on



WestCreek Homes building in:

